

BPW Air Suspension Contents Diagram for Spring Eye Bolt Kit

For correct installation instructions refer to Installation Instructions number INS-09

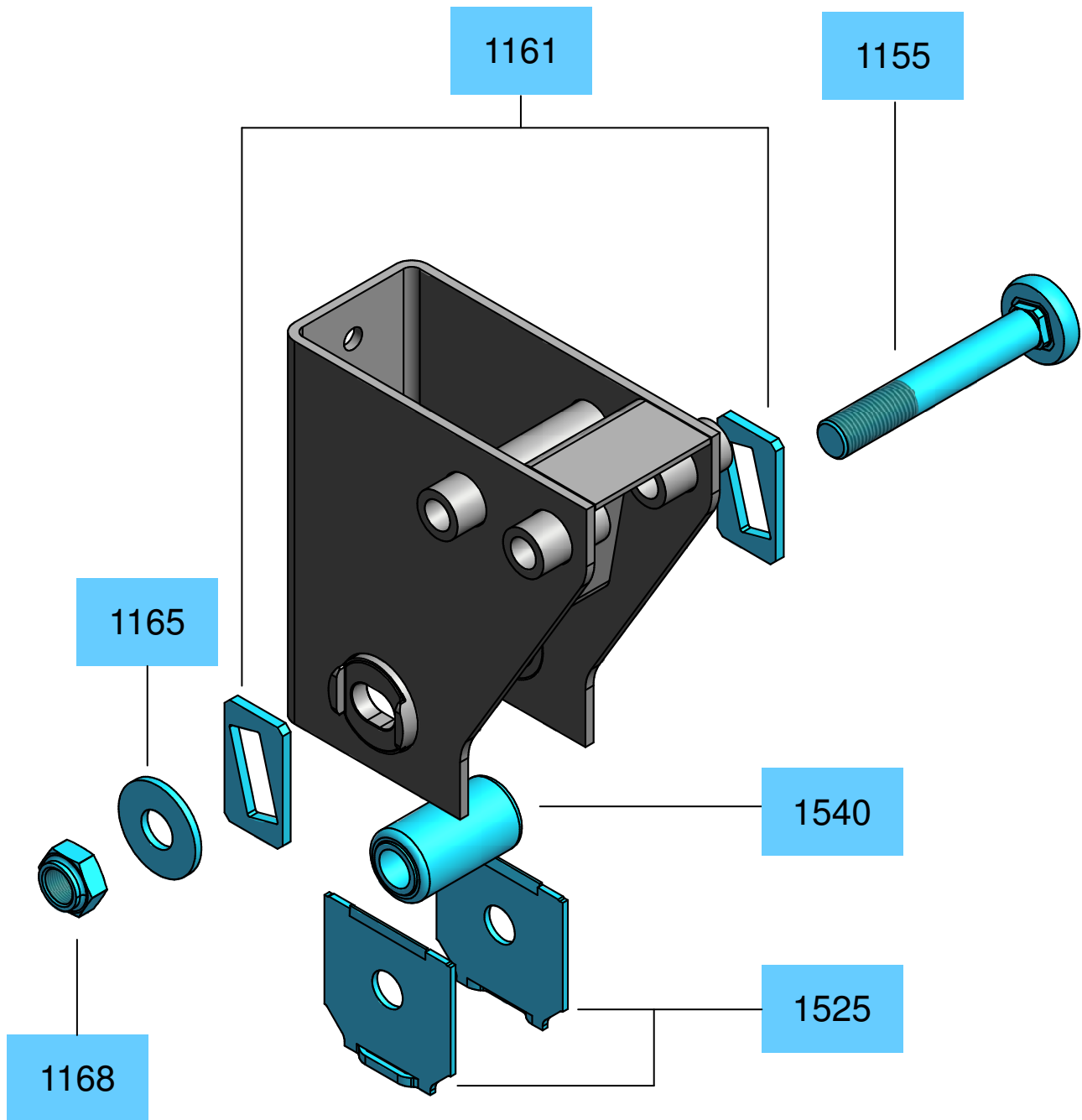

Kit Item Number 0203169KIT-1AL

Description: M30 Spring Eye Bolts, Steel/Rubber/Steel bushes, 100mm Springs, Alignable/Parallel sided Hanger

Kit includes item numbers: 1155 - 1540

Kit includes components to repair one axle

For relevant part numbers refer to the spare parts manuals available from BPW Transpec



For technical information phone 1300 651 652